

THE SIXTH ANNUAL

Los Angeles

PRINTERS FAIR

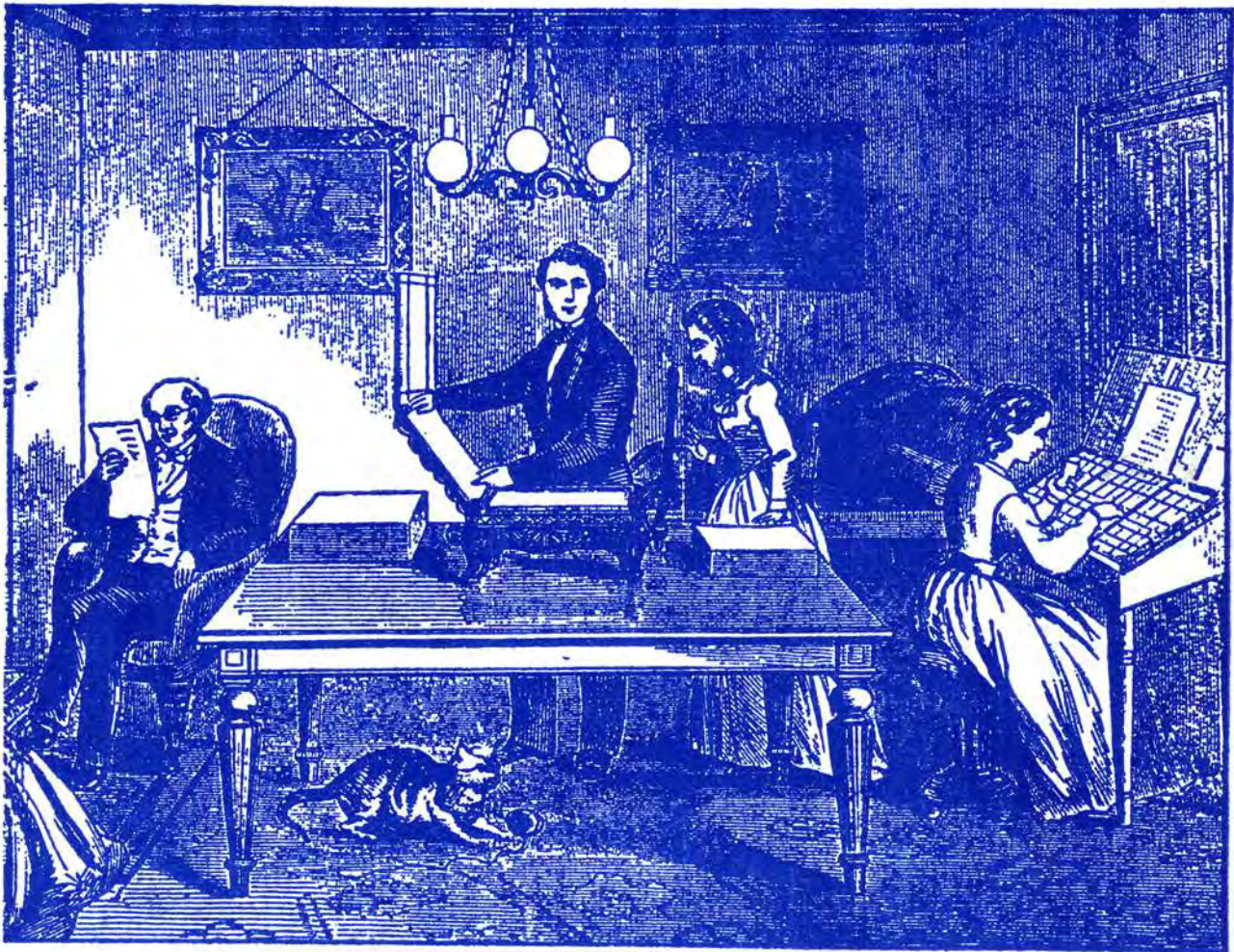

2014





ESTABLISHED IN 1988, THE INTERNATIONAL PRINTING MUSEUM HAS DEVELOPED OVER THE YEARS TO BECOME more than just a repository of Ernie Lindner's great collection of antique presses...it is a living, working experience of the most important invention ever—the printed word! And the LA Printers Fair is a celebration of just that.

When Ernie Lindner began building his beautiful collection of antique printing equipment in the late 1940's, letterpress was still the main commercial process for printing. As a Los Angeles equipment dealer, Ernie would get into the back rooms of many old shops and find their "junk," those obsolete and used printing presses that no longer performed the daily work of the printer. They were destined for the scrap yard but for visionary collectors such as Ernie Lindner. And so he collected for 50 years, building one of the largest collections in the world, with the hope that young printers and artists would someday use those presses again.

In Ernie's day, the term Book Arts was not yet coined; they simply called it Fine Printing—an attention to beautiful printing, paper, type, design and binding. As a tradition, fine printing goes back to the end of the 19th century with the Arts & Crafts Movement and William Morris. The book arts and letterpress revival of today is the inheritor of those ideals of craftsmanship, but with an expansion of expression and creativity. It was always Ernie Lindner's dream to see the presses in his collection to be used and enjoyed by younger generations. Though Ernie died on October 3rd, 2001 his dream is very much alive in the annual Los Angeles Printers Fair at the International Printing Museum held each fall.

Following our 25th Anniversary this last year, the Printing Museum is continuing its Building Campaign to expand and improve the Printing Museum. Details of our Campaign and our initiatives can be found in the Show Guide and on our website. Don't hesitate to support the effort with your donations! We need your help to make this happen and make the Museum even better.

Many thanks go out to our major sponsor, the Printing Industries Association of Southern California and ChoosePrint.org. PIASC remains committed to providing support and education for the printing industry in all of its facets, and educating the public about the Power of Print. Whether you are a large or small print shop they are an industry resource for technical information, training, insurance, and education. Also thanks to Neenah Paper for their continued support, especially with the donation of paper for this year's Show Guide.

The Los Angeles Printers Fair is really only possible because of the energetic and dedicated effort of so many volunteers, docents and staff; thanks to all of them! The proceeds from this event are a major support for the Printing Museum's ongoing educational mission throughout the year, so enjoy your day and buy lots of stuff at the 6th Annual Los Angeles Printers Fair!

Mark Barbour
Executive Director and Curator

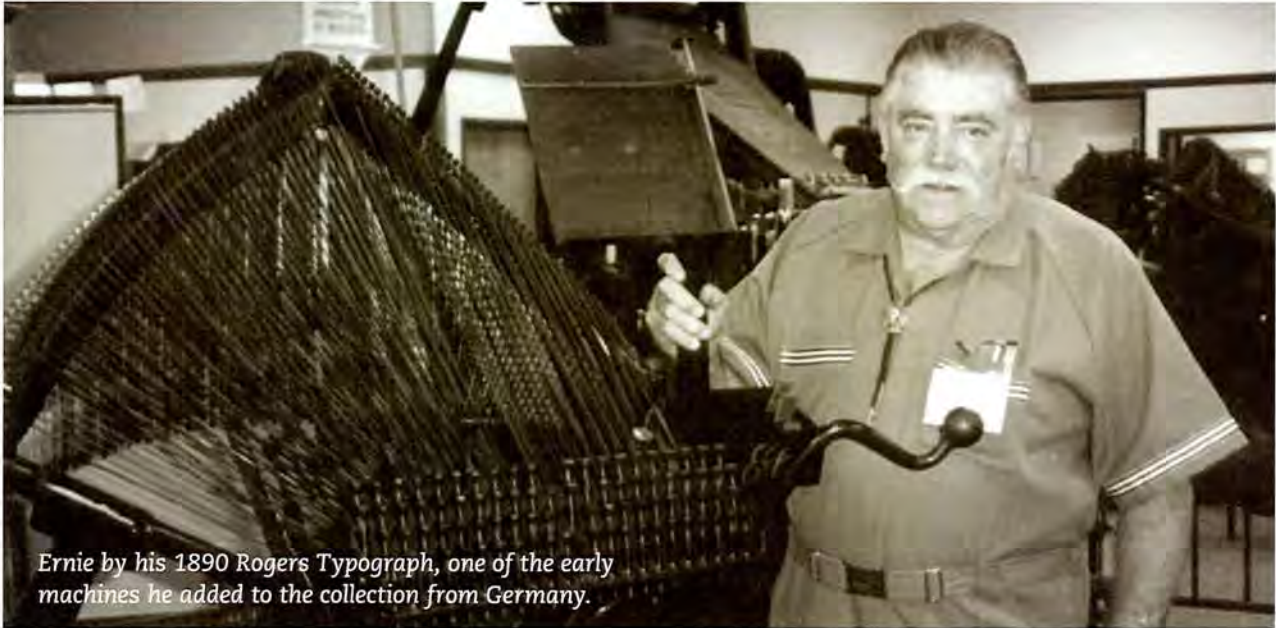

Ernie by his 1890 Rogers Typograph, one of the early machines he added to the collection from Germany.

THE INTERNATIONAL PRINTING MUSEUM Featuring the World Famous Lindner Collection

The International Printing Museum features the Ernest A. Lindner Collection. Recognized by many authorities as the finest collection in the world, the Lindner Collection spans more than 500 years of graphic communication history.

As a young man, Ernest Lindner began collecting while working for his uncle and father who rebuilt and sold used typesetting equipment in Los Angeles. "We would sell a man a machine and take in trade a piece he was replacing. I couldn't bear to throw away some of these wonderful machines, so I began shoving them into corners, even after there were no more corners!"



E.G. Lindner Co. display at the 1968 printing equipment trade show in Los Angeles. Ever the showman, Ernie used pieces from his collection such as the Typograph to attract attention to his exhibit.

After the death of his father in 1940 and his uncle and namesake, Ernest in 1957, Ernie began collecting in earnest. He combed the world searching for old hand-lever presses and typesetting machines that were the wonders of the machine age and assembled one of the largest and finest collections in the world.

Since 1988, Ernie and his wife, Harriet, personally restored many of the pieces on display at the Printing Museum. Though Ernie passed away in October of 2001, the Museum continues to build his legacy by collecting pieces that in Ernie's words, "we just can't do without!"

If you're still using stone-age repro-proofing methods...

it's time you found out about

ASBERN
REPRODUCTION
PROOF PRESSES

... the Repro HEAVYWEIGHTS with the LIGHTWEIGHT touch!

DISTRIBUTED BY:
the E. G. LINDNER co.
Repro Proof Frames • Typesetting Machines • Finishing Equipment
612 E. 12th St., Los Angeles, Calif. 90015
PHONE: (213) 747-4341

Ernie was the national distributor of the Asbern Proof Press, the German version of the now-famous Vandercook. Every American Asbern has a red plate affixed to it with the name E.G. LINDNER CO., LOS ANGELES.

Be Impressed

EXPERIENCE THE INTERNATIONAL PRINTING MUSEUM'S COLLECTIONS AND BE INSPIRED THROUGH WORKING TOURS FROM PRINTING A BIBLE PAGE ON GUTENBERG'S PRESS TO POOR RICHARD'S ALMANACK ON BEN FRANKLIN'S COLONIAL PRESS.

The Museum's galleries are filled with the machines and tools of the graphic arts industry from historic Chinese printing blocks to the cast-iron newspaper presses of the 19th century.

Marvel at the clattering sounds of the 1890 Linotype that changed the world and enjoy the stories of Ben Franklin and how books and printing shaped his life.

THE MUSEUM OFFERS MANY FUN, INTERACTIVE and EDUCATIONAL TOURS

- ▶ The Ben Franklin Gallery Show
- ▶ The Constitutional Convention Tour
- ▶ Ben Franklin's Traveling Colonial Assembly
- ▶ The Book Arts Tour

The Museum's educational programs for schools and groups can be scheduled throughout the year by calling 310-515-7166 or emailing mail@printmuseum.org.

For more detailed information about our programs, visit our website at www.printmuseum.org.

The International Printing Museum is open to the public:

SATURDAY
10 am to 4 pm

TUESDAY thru FRIDAY
By Appointment



25th ANNIVERSARY BUILDING CAMPAIGN

Building Our Future

We need your support to expand and improve!
www.printmuseum.org/building

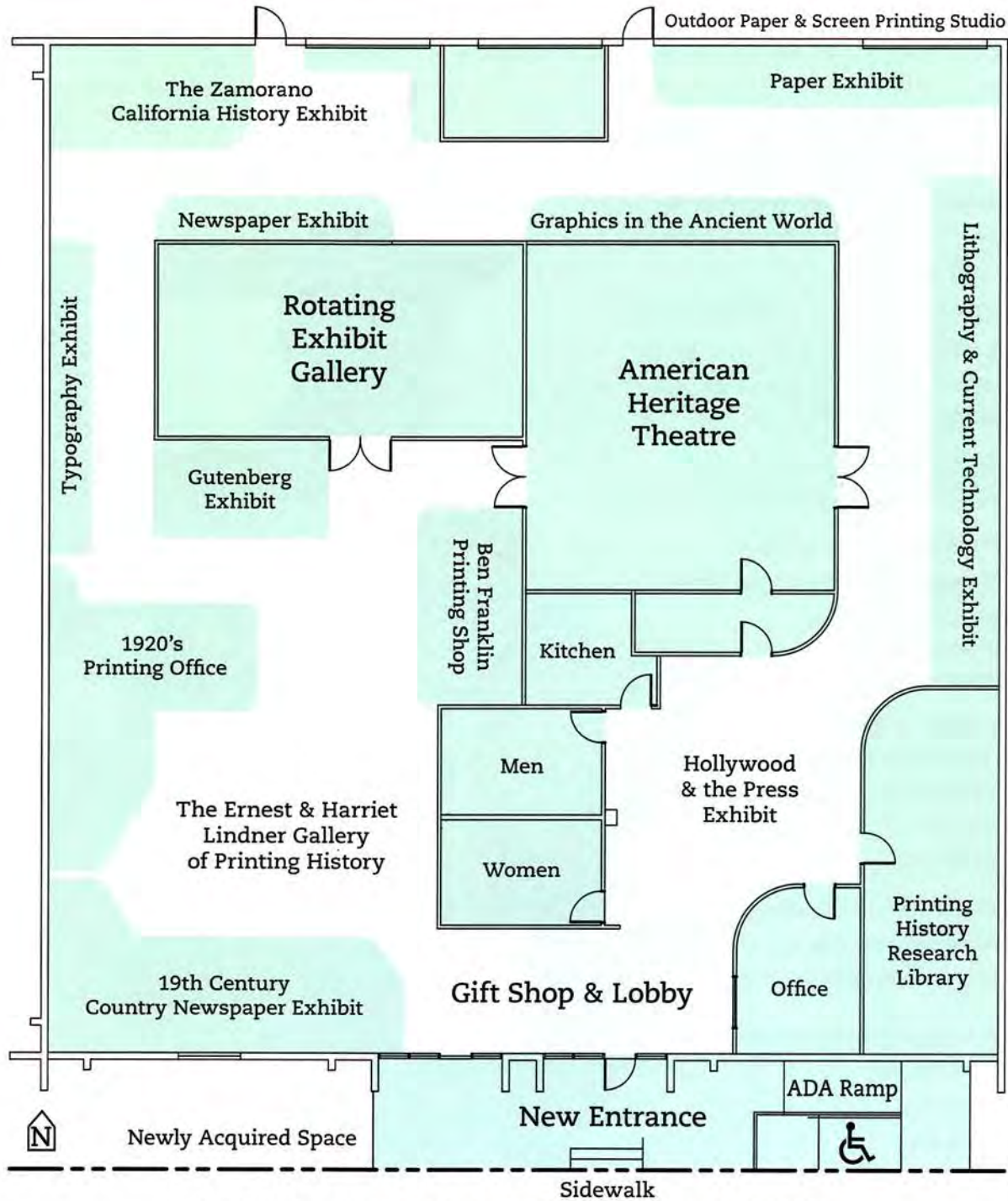

315 W Torrance Boulevard, Carson, California 90745

COMMEMORATING THE INTERNATIONAL PRINTING MUSEUM'S 25TH ANNIVERSARY, THE MUSEUM'S BOARD OF TRUSTEES HAVE LAUNCHED A TWO-YEAR CAMPAIGN TO ENLARGE AND IMPROVE THE CURRENT MUSEUM FACILITIES IN CARSON AND ESTABLISH THE PRINTING MUSEUM FOR ITS FUTURE.

BUILDING CAMPAIGN INITIATIVES

- ▶ Double the existing exhibits and add a Lithography & Current Technology Exhibit
- ▶ Build a new and larger Heritage Theatre and add a Rotating Exhibit Gallery
- ▶ Create two new curriculum-based exhibits and school tours in Ancient History and California History
- ▶ Create a working Papermaking Exhibit and Lab
- ▶ Expand and improve the Museum's Book Arts Institute for teaching classes
- ▶ Establish a Building & Operations Fund for the Museum's future
- ▶ Redesign Museum entrance with an ADA accessible entrance ramp

25TH ANNIVERSARY BUILDING CAMPAIGN GOALS

YEAR ONE: \$500,000 | YEAR TWO: \$500,000

For detailed information about the Building Campaign and how you can participate, please visit our website at www.printmuseum.org/building

A 100% matching grant for all donations made during 2014 has been given by PIASC. Double the value and impact of your contribution by making your donation to the Museum's Building Campaign this year!

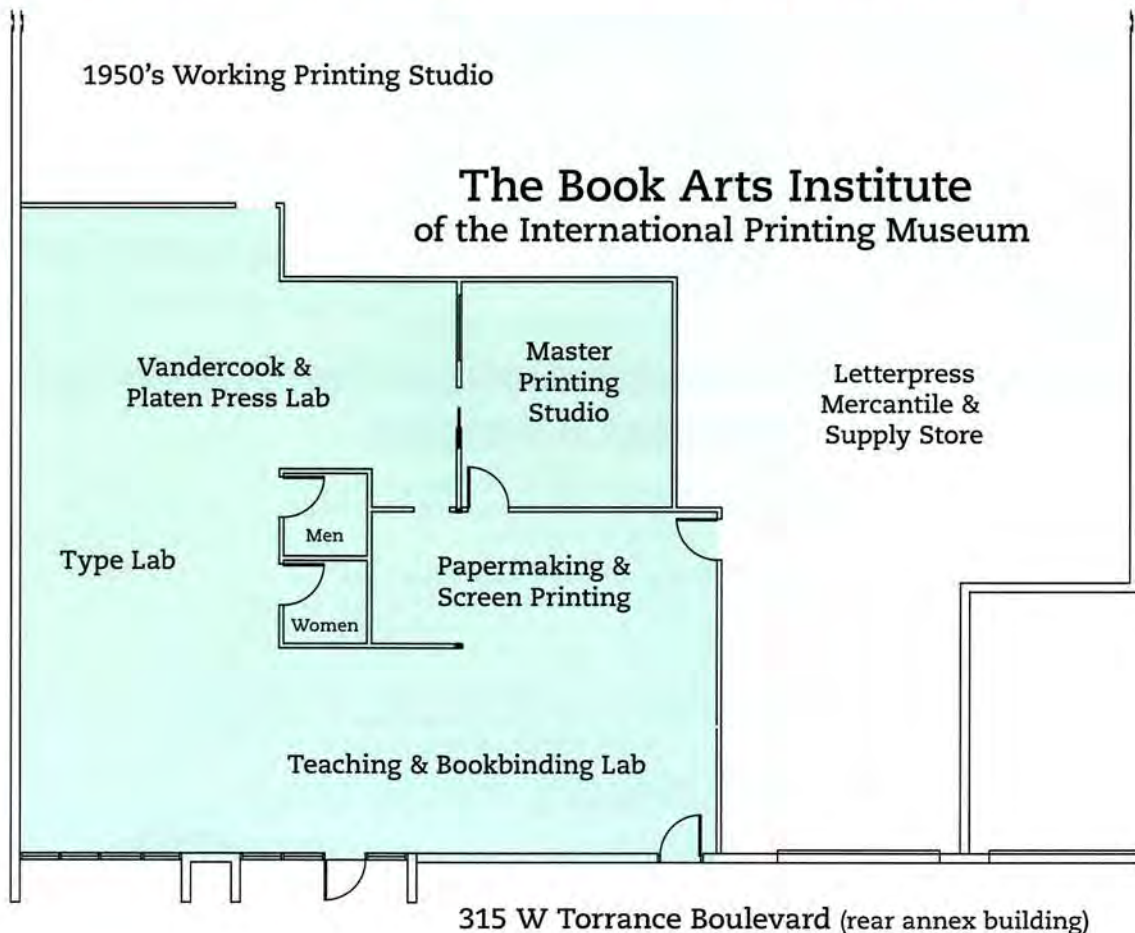



GREATLY NEEDS YOUR

SUPPORT

IT HOUSES ONE OF THE
WORLD'S LARGEST
 WORKING
 COLLECTIONS
 OF
ANTIQUE PRINTING
 MACHINERY

UTILIZING ITS RESOURCES FOR
EDUCATION

DONATE ONLINE THROUGH PAYPAL AT
PRINTMUSEUM.ORG

OR, SEND A DONATION TO

The Printing Museum
 315 W. Torrance Blvd.
CARSON
 California 90745

Become a member even if just at the Basic level, and not only will you sustain the Museum's vital mission, but you will also receive our newsletter, special Museum keepsakes, discounts and members-only invitations to Museum events.

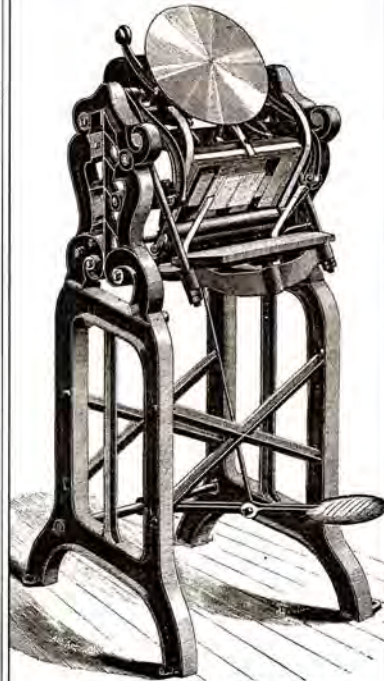

THROUGH ITS EDUCATIONAL TOURS
MUSEUM OF WHEELS
 PROGRAM, CLASSES IN THE MUSEUM'S
BOOK ARTS INSTITUTE
 SPECIAL EVENTS & PRESENTATIONS
 THE MUSEUM REACHES MORE THAN

25,000

STUDENTS AND GUESTS ANNUALLY

LEVELS OF SUPPORT
 OF MUSEUM DONATION

Student Apprentice..... \$25 per year
 Membership
 Basic Annual Membership..... \$50 per year
 Corporate/Family..... \$100 per year
 Membership

More details are available online at
www.printmuseum.org/support/donate

HELP CONTRIBUTE TO THE CONTINUED SUCCESS OF THE MUSEUM WITH YOUR TAX-DEDUCTIBLE DONATION

BECOME A FRIEND

THE CONTINUED SUCCESS of the PRINTING MUSEUM'S work is dependent upon the GENEROUS ANNUAL SUPPORT of its many Friends.

The Printing Museum partially operates with income from its educational and institutional activities, such as admission fees. But fully two-thirds of its budget annually is funded by generous donations from individual and corporate donors from around the country and world. Most of our donors give between \$50 and \$500 annually. Only through our donor base can we meet our ongoing financial needs and keep the Museum's activities growing. We call on every supporter of printing history and the book arts to participate in making the International Printing Museum a permanent reality and help us carry out our mission of

EDUCATION THROUGH PRESERVATION

WWW.PRINTMUSEUM.ORG/SUPPORT/DONATE

DESIGN CREDIT: JOSH KORWIN, THREE STEPS AHEAD



A Celebration of Paper & Print

Saturday, October 4, 2014 | 9 am - 4 pm

Sponsored by



ACTIVITIES

MAIN MUSEUM

- ▶ Ongoing Demonstrations and Tours
- ▶ Colby Poster Company Exhibit
- ▶ Kevin Bradley and Church of Type Poster and Printing Exhibit

BOOK ARTS INSTITUTE

- ▶ Vandercook Printing Demonstrations
- ▶ The Museum's Mercantile Store
- ▶ Linotype Typesetting and Heidelberg Cylinder Demonstrations

EQUIPMENT SALES

- ▶ Opportunity to acquire presses, cutters and supplies at the Museum Surplus Sale

SILENT AUCTION

- ▶ Auction to support the Museum's 25th Anniversary Building Campaign

VENDOR AREAS

- A** Heritage Theater, Main Museum Building
- B** Main Tent
- C** Swap Meet
- F** Museum Surplus Letterpress Sale

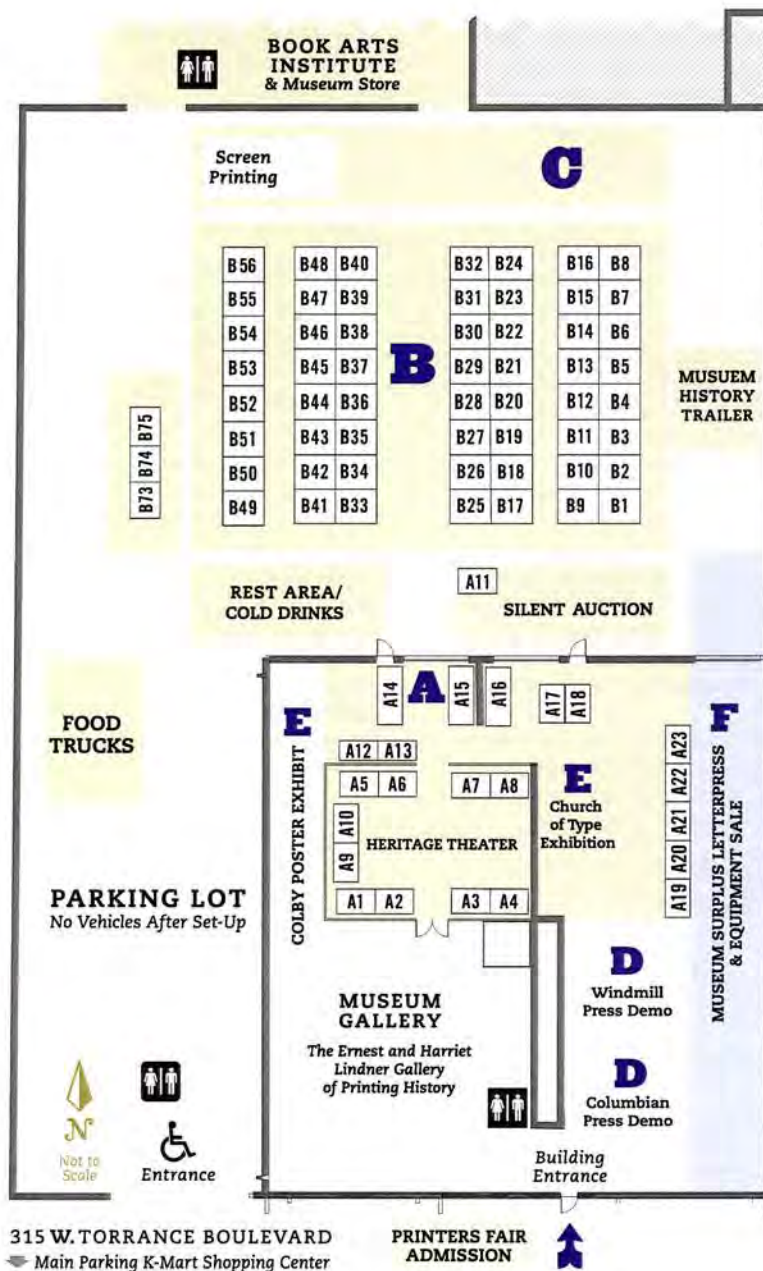

315 W. TORRANCE BOULEVARD
 Main Parking K-Mart Shopping Center

PRINTERS FAIR
 ADMISSION

VENDOR LISTING AND LOCATIONS



A01-A02 ●●●●●

THE BIELER PRESS

Gerald Lange

4216 1/4 Glencoe Avenue
Marina Del Rey, CA 90292
T: 310-821-8269

bieler@att.net

bielerpress.blogspot.com

Gerald Lange founded The Bieler Press in 1975 and has printed and published over fifty titles under its imprint. He offers letterpress typographic and production services for other publishers; specializing in exploratory project-based services and techniques for print production. Currently in production is another chapbook for The Gruffyground Press (UK), *An Elegie* by Ben Jonson.

Lange has provided photopolymer plate processing to the contemporary studio letterpress community since 1995; he wrote the seminal *Printing digital type on the hand-operated flatbed cylinder press*, the definitive manual on the process.

Since 2002, he has taught letterpress printing at Art Center College of Design, which offers his course in their community outreach program.

A03-A04 ●●●●●

PAPERMUM PRESS

Sharon Shin

145 Waverly Drive
Pasadena, CA 91105
T: 626-278-4013

sharon@papermumpress.com

www.papermumpress.com

Papermum Press is a Pasadena based letterpress and design boutique studio owned and operated by Sharon Shin. Sharon has been printing for more than 12 years and is experienced across a wide variety of letterpress equipment.

Her studio consists of 2 Heidelberg Windmills, 2 C&Ps, a Swiss FAG, and a Golding Official. Original Kupchick Letterpress, represented by and contact through Papermum Press: A line of cards by Janet Kupchick, long time art director, who currently just uses other people's presses.

A05 ●●

KRANK PRESS

Elinor Nissley

1475 Silver Lake Boulevard
Los Angeles, CA 90026
T: 323-792-8850

krankpress@gmail.com

www.krankpress.com

Krank Press is the work of printer (and architect!) Elinor Nissley. She prints (letterpress, relief & silkscreen) out of her garage workshop in Silver Lake, with a particular interest in documenting Los Angeles history, flora & fauna.

A06 ●●●

MODERN OPTIC

Leslie Ross-Robertson

3141 S Durango Avenue
Los Angeles, CA 90034

T: 310-287-0845 C: 310-733-8157

modernoptic@gmail.com

www.modern-optic.com

www.wavelengthpress.com

Modern Optic is a letterpress studio established by artist Leslie Ross-Robertson in 2001. Leslie has produced two lines of stationery and prints. In 2012, Leslie started Wavelength Press, focusing on collaboration with artists producing special edition prints.

She is currently teaching Digital Letterpress for Continuing Education at Otis College of Art and Design.

A07 ●●

PIE IN THE SKY PRESS

Rebecca Chamlee

6785 Cowboy Street
Simi Valley, CA 93063

T: 805-479-4665 C: 805-479-4665

pieintheskypress@mac.com

www.pieintheskypress.com

Pie In The Sky Press is a small private press operated by book artist, designer, letterpress printer and binder Rebecca Chamlee in Ventura County, California that specializes in limited edition artist books and fine press books by selected poets and writers.

A08 ●●●●

ERYNN & CAMILLA

Camilla Taylor & Erynn Richardson

1250 Long Beach Avenue, Unit 223
Los Angeles, CA 90021

T: 602-821-5655

camilla.a.taylor@gmail.com

www.erynnrichardson.com

www.camilla-taylor.com

We specialize in quality handmade and printed ephemera.

A09 ●

JILL K. IN LA

Jill Kleinhans

5216 Rockland Avenue
Los Angeles, CA 90041

T: 323-449-1828

jillolives@yahoo.com

www.jillkinla.etsy.com

Jill K. in LA is a master block printer and one-woman crew creating and peddling original art prints and handmade greeting cards with a colorful, often humorous, flair. She has gained much recent acclaim for her custom NUDE block printed portraits.

A10 ●●●●●

CLASSIC LETTERPRESS

Norman Clayton

756 S Rice Road
Ojai, CA 93023

T: 510-579-0777

letterpress@mindspring.com

www.classicletterpress.biz

We offer some of the highest quality letterpress printing available. We have the capacity to print up to 18"x23" and can include type reversed to paper, tight registration, and large ink coverage. We also teach and offer internships.

A11 ●●●●●

BUDDHA CAT PRODUCTIONS

Karen Fiorito

2318 6th Street
Santa Monica, CA 90405

T: 310-868-6058 C: 310-868-6058

karenfiorito@gmail.com

buddhacatpress.blogspot.com

Buddha Cat Press is a fine art print publisher owned and operated by Karen Fiorito.

VENDOR LISTING AND LOCATIONS

A12 ①

TYPEED

Rachel Elnar

411 S Main Street, Unit 615
Los Angeles, CA 90013

T: 213-623-7267 C: 626-625-6026

rachel@type-ed.com

www.type-ed.com

TypeEd is bringing the craft of typography back to design education. We exist to protect and serve the letterform. Join us in our quest to typeset against the villains of bad typography.

A13 ②③

STACY WONG

1640 23rd Street
Manhattan Beach, CA 90266

T: 310-464-7379 C: 310-464-7379

stacywong34@gmail.com

www.stacywonghandmade.com

Handmade, artful objects including art prints, real wood cards, notebooks, and supplies for creative diy makers.

A14 ①②③④

JUST VANDY

Heather & Larry Mitchell

22618 Kathryn Avenue
Torrance, CA 90505

T: 310-408-4204

info@justvandy.com

www.justvandy.com

Just Vandy is a small letterpress studio specializing in custom printing services to individuals and the design industry. In addition to job work, we have a line of letterpress stationery characterized by its expressive typography, use of space and color.

Our self-published book, *The Vandercook 100*, celebrates 100 years of printing on the Vandercook proof press (1909–2009) and showcases 100 of today's most significant letterpress printers who use the Vandercook press.

A15 ②③

LETTERPRESS CENTRAL/THE PAPER STUDIO

Cindy Iverson

PO Box 11390
Tempe, AZ 85284

T: 480-557-5700 C: 480-234-6604

hello@letterpresscentral.com

www.letterpresscentral.com

We do custom letterpress printing and create mixed media artwork. Our unique experience merges art, design and craft. We collaborate with companies, designers and individuals to produce work with a tactile feel and a lasting impression.

A16 ②③

A&G ENGRAVING

Andy Frumento

3846 S Santa Fe Avenue
Los Angeles, CA 90058-1713

T: 323-583-9085 C: 323-816-7067

info@aandgengraving.com

www.aandgengraving.com

A & G Engraving, Inc., Southern California's largest photoengraver, manufactures the highest quality photoengraving of magnesium dies, copper dies. We specialize in letterpress engravings! We can provide all of your film requirements, negatives and positives produced same day. No job too small, special prices for larger jobs. *Se Habla Español*

A17 ②③④

LOS ANGELES

PRINTMAKING SOCIETY

Mary Sherwood Brock,

LAPS exhibitors

PO Box 1547

Pasadena, CA 91031

T: 323-251-9702

studiosherwood@sbcglobal.net

www.laprintmakers.com

The Los Angeles Printmaking Society (LAPS) is a national non-profit dedicated to the encouragement of printmaking, educating the public and promoting the interests of printmaking as a fine art form. Founded in Los Angeles in 1963 to encourage the art and dialogue around printmaking, LAPS sponsors notable print exhibitions in southern California, including international exchanges and our biennial, the LAPS National. Each year we encourage local student printmakers with LAPS Foundation grants.

A18 ①

PAPER PASTRIES

Margaret Haas

1007 S Ditmar Street
Oceanside, CA 92054

T: 562-852-1680

paperpastries@gmail.com

paperpastries.bigcartel.com/products

Personal stationery, custom rubber stamps, and lino block prints

A19 ②③

FUGU FUGU PRESS

Ken and Shino Charlson

3622 Monterosa Drive
Altadena, CA 91001

T: 626-826-3287

fugufugupress@gmail.com

www.fugufugupress.com

We are Ken and Shino. We have a dog named Morgan. We have a Vandercook and two Heidelberg Windmill presses. We print using environmentally friendly methods and materials. We hope you enjoy our cards as much as we do making them!

A20-A21 ②③

JOIE STUDIO DESIGN AND LETTERPRESS

Tina Pham

PO Box 2574

Pasadena, CA 91102

T: 626-628-9697

joiestudio@gmail.com

www.joiestudio.com

Located in Pasadena, California, Joie Studio Design and Letterpress is an artisan design studio specializing in letterpress paper goods. We letterpress everything in house using one of our three antique presses.

A22 ②③④

PICTURE BOOKS

Ruth Lingren

368 E 8th Street, Unit 6F
New York, NY 10009

T: 917-385-2135

ruthlingen@yahoo.com

Ruth Lingen collaborates with artists in various print & paper making techniques for limited edition books and prints. She works in Brooklyn with mostly local artists. Several other small presses in NYC will be shown.

① Letterpress/Printing Services ② Letterpress/Printing Supplies or Equipment ③ Graphic Design Services

④ Printmaking/Photography ⑤ Book Arts/Artist Books/Rare Books ⑥ Paper ⑦ Education/Courses ⑧ Miscellaneous

A23 (5)

OTIS LAB PRESS

Linda Dare
9045 Lincoln Boulevard
Los Angeles, CA 90045
T: 310-665-6846 C: 310-486-7010
ldare@otis.edu
<https://blogs.otis.edu/labpress/>
Otis College of Art and Design BFA program offers a Book Arts Minor. The Continuing Education program has Introductory and Digital Letterpress classes as well as Book Structures throughout the year.



B01-B02, B09-B10

LETTERPRESS THINGS

John Barrett
55 N Chicopee Street
Chicopee, MA 01020
T: 413-222-9029 C: 413-222-9029
letterpressthings@gmail.com
www.letterpressthings.com

Located in Western Massachusetts, a neat little store with type, tools, supplies and equipment for the letterpress printer.

B03-B04 (2)

KELLY PAPER

Ana Perez
288 Brea Canyon Road
City of Industry, CA 91789
T: 909-859-8200 C: 562-457-9655
kpinfo@kellypaper.com
www.kellypaper.com

Family owned and operated for nearly 80 years, Kelly Paper has always been your partner in paper. From commercial offset

printing to in-house digital, we stock the best paper for your best results.

B5 (3)

WASHI ARTS

Linda Marshall, Suite 1-413
San Francisco, CA 94107
T: 415-886-7096 C: 415-549-6845
lindamarshall@mac.com
www.washiarts.com

Washi Arts carries premium hand and machine made Japanese papers for printers, book artists, printmakers, designers, fine artists, calligraphers and bookbinders. A great source for kozo and gampi washi, chiyogami and katazome-shi.

B06 (2)

JOSEPH FAZIO

T: 714-202-2466 C: 714-501-4682
vintoys@att.net
Vintage; Pearl treadle Press, Hamilton 2/3 cabinet, lead & wood type, tabletop hand presses, cuts and miscellaneous.

B07 (3)

PRINTING INDUSTRIES ASSOCIATION (PIASC)

Jay Haddad
5800 S. Eastern Ave Suite 400
Los Angeles, CA 90040
T: 323-728-9500
jay@piasc.org
<http://www.piasc.org>

As a small letterpress printer you need to keep your business expenses under control. Whether you need health or business insurance, discounted rates on your credit card merchant fees, discounted shipping rates with UPS, or any other assistance with running your business, PIASC can help.

B08 (3)

THE LIBRARY PRESS

Amy Gonzales
10241 Kamuela Drive
Huntington Beach, CA 92646
T: 714-501-2627
librarypress@gmail.com
www.thelibrarypress.com

A tiny design and print studio! Letterpress goods printed on a Chandler + Price letterpress affectionally called Eisenhower.

B11 (1)

INK IN TUBES

Dave Robison
20531 Black Road
Los Gatos, CA 95033
T: 408-354-4666
ink@orchidesign.com
www.inkintubes.com

Ink in Tubes: Convenient quarter pound tubes of printing ink in a wide variety of Pantone and other colors, including metallics and fluorescents. Saves time, money, and space; no wasted ink, easy to use.

B12 (2)

FRENCH PAPER

Dorothy Loo
1836 Fifth Street
Manhattan Beach, CA 90266
T: 310-503-7205 C: 310-503-7205
loo@frenchpaper.com
www.frenchpaper.com

102 colors and textures uncoated text and cover papers—prints letterpress, engraving, silk screen, offset and digital—made in the USA with our own fossil-fuel-free energy

B13 (2)

RAMCO ROLLER PRODUCTS

Jayne Ramos
241 W Allen Avenue
San Dimas, CA 91773
T: 909-592-1002 C: 626-327-5858
adrian@ramcoroller.com
www.ramcoroller.com

Need new rollers for any press? Small or large, we recover with new rubber and even make most cores and trucks if needed. Ramco Roller Products has been recovering rollers since 1983!

B15 (1)

NEENAH PAPER

Jill Dunleavy
1376 Kimberly Drive
Neenah, WI 91501
T: 714-279-8771 C: 714-408-0329
jill.dunleavy@neenah.com
www.neenahpaper.com

Neenah Paper manufactures premium writing, text and cover papers including well-known brands such as CLASSIC, ENVIRONMENT, ROYAL SUNDANCE and ASTROBRIGHTS. CRANE'S LETTRA is also offered by Neenah Paper

✦ VENDOR LISTING AND LOCATIONS ✦

B16 ●●●●●

POLI MARICHAL ART STUDIO

Poli Marichal

411 N Fuller Avenue

Los Angeles, CA 90036

T: 323-877-1767 C: 323-655-1275

polimarichal@sonic.net

www.polimarichal.com

Poli Marichal Studio specializes in limited edition fine art prints created by artist Poli Marichal. Among the techniques used are: linocut, woodcut, monotype, monoprint, drypoint and etching. Marichal also conducts printmaking workshops for students, teachers and professional artists.

B17 ●●●●●

DE MILO DESIGN STUDIO & LETTERPRESS

Annika Buxman

1401 Mission Street, Unit 103

South Pasadena, CA 91030

T: 626-403-0317

annika@demilodesign.com

www.demilodesign.com

De Milo specializes in custom letterpress printing, "Sustain & Heal" fair trade and eco friendly handmade marble paper, and letterpress classes.

B18 ●●●●

DTLA PRINT

Linda Marie Alvarez

1261 S Boyle Avenue

Los Angeles, CA 90023

T: 323-261-8700

sales@dtlaprint.com

www.dtlaprint.com

With 25+ years of experience, DTLA Print has mastered and perfected the art of screen printing, specializing in Specialty Inks and Photo-realistic prints. We also offer dye sublimation printing and an array of finishing services to suit your needs.

B19 ●●●●

WARREN TALES

Lindsey Warriner

633 Alameda Boulevard

Coronado, CA 92118

T: 619-865-0671 C: 619-865-0671

warrentales@gmail.com

www.warrentales.com

Warren Tales is an independent paper craft studio and functions as a digital press, complemented by hand-typed and handmade products. Our unique cards are created, cut, packaged, and plucked by unique humans to ensure the finest quality and letter-writing experience.

B20 ●●●●

HYACINTH PRESS

Joseph Vorgity

348 S Burnside Avenue

Los Angeles, CA 90036

T: 323-383-2222

josephvorgity@msn.com

www.josephvorgity.com

Hyacinth Press produces hand made woodblock printed greeting cards. The card images are original, limited edition, hand pulled woodblock prints.

B21 ●●●●

IRVINE FINE ARTS CENTER

Marelyn Larios

14321 Yale Avenue

Irvine, CA 92604

T: 949-724-6881

mlarios@cityofirvine.org

www.irvinesinearts.org

The Irvine Fine Arts Center's Printmaking Studio is a fully equipped studio suited for traditional printmaking and letterpress. Classes are available in various techniques. Open Studio by reservation only; orientation required.

B22 ●●●●

AMERICAN PRINTING HISTORY ASSOCIATION, SOUTHERN CALIFORNIA (APHASC)

Nina Schneider

4188 Angeles Vista Boulevard

Los Angeles, CA 90008

T: 323-731-8529 C: 917-334-7193

info@aphasocal.org

www.printinghistory.org/chapters/southern-california

The American Printing History Association (APHA) is a membership organization that encourages the study of the history of printing and related arts and crafts, including calligraphy, typefounding, typography, papermaking, bookbinding, illustration, and publishing.

B23 ●●●●●

HIROMI PAPER

Yona Warmin

2525 Michigan Avenue, Unit G-9

Santa Monica, CA 90404

T: 310-998-0098 C: 310-717-9652

yona@hiromipaper.com

www.hiromipaper.com

Established for over 25 years, Hiromi Paper has built close working relationships with Japanese papermakers and paper users all over the world. Hiromi Paper not only strives to support papermakers and the paper making traditions, but to also grow with the present and future needs from the people who use the paper. We carry handmade and machine made papers, in large size and in rolls, along with custom made Japanese paper for your special project.

B24 ●●●●

LEGION PAPER

Marc Schotland

6333 Chalet Drive

Los Angeles, CA 90040

T: 800-727-3716

paige@legionpaper.com

www.legionpaper.com

Legion Paper has a long history of being the company that other paper merchants come to for new and innovative products. We work closely with our mills in 16 countries to develop and distribute the most interesting and best-performing papers available. From your every day 'house sheet' to the most exotic papers you can imagine (and everything in between), we either stock it, can source it or can create it.

B25 ●●●●

LIFE IS FUNNY PRESS

Adam Smith

1171 Centinela Avenue

Santa Monica, CA 90403

T: 310-597-9204

adam@lifeisfunnypress.com

www.lifeisfunnypress.com

Life Is Funny Press is a letterpress company based here in sunny LA. Keepin' it real since 2009.

- ① Letterpress/Printing Services ② Letterpress/Printing Supplies or Equipment ③ Graphic Design Services
 ④ Printmaking/Photography ⑤ Book Arts/Artist Books/Rare Books ⑥ Paper ⑦ Education/Courses ⑧ Miscellaneous

✦ VENDOR LISTING AND LOCATIONS ✦

B26

TYPECRAFT WOOD & JONES

Hanna Wood

2040 E Walnut Street
Pasadena, CA 91107

T: 626-795-8093 C: 626-695-2028

info@typecraft.com

typecraft.com

Ooooo! Typecraft!

GORGEOUS LUXURIOUS COLORFUL
SENSUAL ARTISTIC PRINT

B27

C.J. WHITLOCK

Cindy Whitlock

3448 Lime Avenue
Long Beach, CA 90807

T: 562-424-6362

cj.whitlock.art@gmail.com

Letterpress printed linocut stationery
and prints.

B28

KISS AND PUNCH DESIGNS

Julie Stewart

1825 Selby Avenue, Unit 101
Los Angeles, CA 90025

T: 310-428-0858

info@kissandpunch.com

www.kissandpunch.com

Small and sassy design studio in Los
Angeles creating charming and stylish
letterpress goods.

B29

HARRY DIAZ

26615 Marigold Court
Calabasas, CA 91302

T: 323-270-3652 C: 323-270-3652

info@harrydiaz.com

www.harrydiaz.com

Harry Diaz is a Guatemalan born
illustrator and print-maker living and
working in Los Angeles, California.

B30

ASTRO PAPER

Michael Augustiniak

155 Mata Way, Unit 101
San Marcos, CA 92069

T: 760-445-3291

mikea@astropaper.com

www.astropaper.com

Astro Converts stocks papers and
envelopes from the finest specialty paper
mills across the world to provide the

greatest selection of paper products. We
have no order minimums making us your
one-stop shop for paper and accessories!

B31

ANEMONE LETTERPRESS

Carrie Howe Hersom

1087 N Garfield Avenue
Pasadena, CA 91104

T: 626-200-9693

anemone.letterpress@gmail.com

www.anemoneletterpress.com

Fun and fresh letterpress from SoCal!

B32

TWO HAND DESIGN

Victoria Cole

PO Box 940864
Simi Valley, CA 93094

C: 805-791-7300

twohanddesign@yahoo.com

www.twohanddesign.com

Two Hand Design is a small design
and print company based in Southern
California. Products include greeting
cards, prints, notepads and anything else
I can get my Kelsey tabletop to print on!

B33 & B41

MARGINS

Jeremy Rendina

516 Magnolia Street
South Pasadena, CA 91030

T: 213-280-6997

info@marginsimprint.com

www.marginsimprint.com

Through our studio imprint, we produce
original and archival serigraphs
(silkscreen), letterpress, and Giclée
prints. A special emphasis is given to
texture and intricate printing techniques.
We make every effort to work in
accordance with sustainable printing
practices that support the well-being
of all living creatures and the greater
ecological system of which we belong.

B34

EVA SVITEK

15 Los Vientos Drive
Newbury Park, CA 91320

T: 805-499-9813 C: 805-390-1583

evasvitek@gmail.com

I was born and raised in Prague, Czech
Republic and studied graphic art at
the Charles University. Although art
was limited to my spare time for a long
time, I was able to revive my passion

from college years. I enjoy working with
relief and intaglio techniques as well as
monotype. Lately I have explored the art
of handmade artists' books as a flexible
medium with a wide range of artistic
expression and a creative way how to
utilize my prints.

B35

PANICLE

Cheryl Buhler & Paula Spence

PO Box 8691
Fountain Valley, CA 92728

T: 714-623-8383

panicledesign@earthlink.net

www.etsy.com/shop/panicle

Panicle is a studio of selected artists
who focus on printmaking and other
creative arts.

B36

MARIE KELZER DESIGNS

Marie Kelzer

4080 Glencoe Avenue, Unit 424
Marina del Rey, CA 90292

T: 310-437-0596 C: 415-225-6905

mariekelzerdesigns@yahoo.com

www.mariekelzerdesigns.com

Bookbinder, Book Artist and Paste Paper
maker for over 20 years. Hand painted
Paste Papers available in sheets and
scraps for paper crafts, bookbinding
and licensing. Hand bound journals and
books, note cards and artworks from
paste papers.

B37-B38

BOOKARTSLA

Marcia Moore

11720 Washington Place
Los Angeles, CA 90026

T: 310-722-9004 C: 310-722-9004

marcia@netjunki.org, info@

bookartsla.org

www.bookartsla.org

Welcome to BookArtsLA, a new non-
profit organization devoted to bringing
the beauty of printing, binding and
collecting artists' books and other hand
made books to the public. Our 1600
square foot space houses letter presses,
a bindery and workspace for up to 20
students. Please visit our website for
classes offered.

✦ VENDOR LISTING AND LOCATIONS ✦

B39 ①

NANIKATSU

Yuichiro Ohnishi
3-8-11 oyodo-naka kita-ku
Osaka, JP 531-0076
T: +81-6-6453-2041
c5oons@yahoo.co.jp
kappan.did.co.jp

NANIKATSU is a letterpress studio based in Osaka, Japan. We offer letterpress printed cards and custom paper goods.

B40 ①②③④⑤⑥⑦

GUILD OF BOOK WORKERS, CALIFORNIA CHAPTER

Marlyn Bonaventure
811 N Cambridge Street
Orange, CA 92867
T: 714-639-4010
california@guildofbookworkers.org
gbwcaliforniachapter.wordpress.com

From book production to restoration, from collections to conservation, the CA Chapter of the GBW fosters the book arts from cover to cover. Talk to us about our workshops, exhibitions and events.

B42 ③④

PARASOL PAPERWORKS

Christiane Suzuki
1405 W Lincoln Avenue
Montebello, CA 90640
T: 323-721-3742
chrissuzuki@sbcglobal.net

Origami and paper designed jewelry, artwork, note cards and small gift items.

B43 ③

VIGODAPRESS

Gwido Zlatkes
3708 Beechwood Place
Riverside, CA 92506
T: 951-782-8528 C: 951-250-0158
flv@vigodapress.com
www.vigodapress.com

VigodaPress is a small independent publisher/printer of hand-crafted artists' books, primarily translations from Polish poetry, and sheet music of original scores. VigodaPress is the exclusive US distributor of artists' books by the Book Art Museum of Lodz, Poland.

B44 ③④

ANNAMARIE LEON & ALEC DYE

6738 Aldea Avenue
Lake Balboa, CA 91406
T: 714-269-7578
veremos.print@gmail.com
www.veremosprint.co
www.alecdye.com

Two printmakers hailing from the San Fernando Valley bringing you hand pulled prints of surreal cityscapes, linear abstractions, and the occasional necessary absurdity.

B45 ③④

KATER-CRAFTS BOOKBINDERS

Bruce Kavin
4860 Gregg Road
Pico Rivera, CA 90660
T: 562-692-0665 C: 562-533-5226
sales@katercrafts.com
www.katercrafts.com

Kater-Crafts Bookbinders is a family owned business with over 65 years experience in binding and restoring books.

Our bindery services include edition binding, custom portfolios, menu covers, gift books, slipcases and clamshell boxes. Preservation services include book restoration, conservation of works on flat paper and Mylar encapsulation.

B46-B48 ③

SKYLINE TYPE FOUNDRY LLC

Schuyler Shipley
PO Box 12816
Prescott, AZ 86304-2816
T: 928-237-5525 C: 314-805-3369
sky@skylinetype.com
www.skylinetype.com

Foundry-cast metal type fonts, borders, ornaments, and decorative initials. Our matrix library contains about 3,000 fonts and some 2,000 different ornamental elements. We specialize in 19th-century type face revivals. Visitors welcome!

B49 ③

ALEXANDRA GAGNE

10977 Bluffside Drive, Unit 1412
Studio City, CA 91604
alex.n.gagne@gmail.com

B50 ③④⑤⑥

POET & PEASANT PRESS

Alex Jackson
1061 Tulare Drive
Costa Mesa, CA 92626
T: 714-852-1789
alexjaxson@yahoo.com

A rather fine assortment of printed matter: fine books, stationary, and various curiosae obscurum produced by members of the greater relief printing family.

B51 ③④

OCCIDENTAL COLLEGE

Jocelyn Pedersen
1600 Campus Road
Los Angeles, CA 90042
T: 323-854-7281 C: 323-854-7291
pedersen@oxy.edu
<http://www.oxy.edu/library/special-collections-college-archives/visual-book-arts>

The Occidental College Book Arts Program is sponsored by the Lawrence Clark Powell and Fay Shoemaker Powell Endowment. We teach undergraduate courses in Letterpress Printing, Handprinted Book Production, Hand Papermaking and Artist Books.

B52 ③

WNY BOOK ARTS CENTER

Chris Fritton
468 Washinton Street
Buffalo, NY 14203
T: 716-348-1430
chris@wnybookarts.org
www.wnybookarts.org

B53 ②

ADVANCED ROLLER COMPANY

Denny Woodruff
212 Lewis Court, Corona, CA 92882
T: 951-272-3010
office@advancedroller.com
www.advancedroller.com

We manufacture Printing Press Rollers for the graphic arts industry.

- ① Letterpress/Printing Services ② Letterpress/Printing Supplies or Equipment ③ Graphic Design Services
④ Printmaking/Photography ⑤ Book Arts/Artist Books/Rare Books ⑥ Paper ⑦ Education/Classes ⑧ Miscellaneous

B54 ○○○○○○

PANORAMA PRESS

Madeleine Zygaewicz
4700 York Boulevard
Los Angeles, CA 90042
T: 323-893-8058 C: 323-893-8058
madeleine@thepanoramapress.com
www.thepanoramapress.com

In fast-paced, modern life, Panorama Press inspires us to slow down and appreciate the tangible work of letterpress. Our approach is that designs really come to life in letterpress. We love sharing our obsession of letterpress by offering private and group classes. We're excited to launch our new, expanded studio—Panorama Press House—in Highland Park in late fall 2014.

B55-B56 ○

VALLEY PRINT STUDIO

Miles Lewis
5210 Collier Place
Woodland Hills, CA 91364
T: 818-390-2215
valleyprintstudio@gmail.com
valleyprintstudio.com

The Valley Print Studio's mission is to serve professional art-production and community education, through the arts of traditional printmaking. The Studio also serves as a hub for drawing and painting workshops, in the San Fernando Valley. Please Note: We've recently opened a residency program for artists from outside of Southern California!

B73-B75 ○

CALIFORNIA MACHINERY MOVERS

Jim Salazar Company
1467 Lincoln Avenue
Pasadena, CA 91103
T: 800-675-1548
info@californiamachinerymovers.com
www.californiamachinerymovers.com

We specialize in printing equipment catering to hobbyist printers, provide machinery moving, and are involved in equipment sales.



C05 ○

TIKIRANCH

Randall Jones
5442 Yale Avenue
Westminster, CA 92683
T: 562-243-1815 C: 562-243-1815
tikiranch@yahoo.com
www.tikiranch.blogspot.com

Vintage paper, matchbooks, magazines, greeting cards and loads of other vintage graphic inspiration.

**Who Knows
What Treasures
You'll Find at
the Los Angeles
Printers Fair?**

- ① Letterpress/Printing Services
- ② Letterpress/Printing Supplies or Equipment
- ③ Graphic Design Services
- ④ Printmaking/Photography
- ⑤ Book Arts/Artist Books/Rare Books
- ⑥ Paper
- ⑦ Education/Classes
- ⑧ Miscellaneous



VENDOR INDEX

1 LETTERPRESS/PRINTING SERVICE

- A01-A02 The Bieler Press
- A03-A04 Papermum Press
- A05 Krank Press
- A06 Modern Optic
- A10 Classic Letterpress
- A11 Buddha Cat Productions
- A14 Just Vandy
- A15 Letterpress Central/The Paper Studio
- A16 A&G Engraving
- A19 Fugu Fugu Press
- A20-A21 Joie Studio Design and Letterpress
- B07 Printing Industries Association (PIASC)
- B08 The Library Press
- B17 De Milo Design Studio & Letterpress
- B18 DTLA Print
- B19 Warren Tales
- B23 Hiromi Paper
- B25 Life Is Funny Press
- B28 Kiss and Punch Designs
- B31 Anemone Letterpress
- B37-B38 BookArtsLA
- B39 Nanikatsu
- B40 Guild of Book Workers, California Chapter
- B50 Poet & Peasant Press
- B54 Panorama Press
- B55-B56 Valley Print Studios

2 LETTERPRESS/PRINTING SUPPLIES OR EQUIPMENT

- A01-A02 The Bieler Press
- A15 Letterpress Central/The Paper Studio
- A16 A&G Engraving
- B01-B02, B09-B10 Letterpress Things
- B03-B04 Kelly Paper
- B05 Washi Arts
- B11 Ink In Tubes
- B13 Ramco Roller Products
- B17 De Milo Design Studio & Letterpress
- B24 Legion Paper
- B31 Anemone Letterpress
- B33, B41 Margins
- B46-B48 Skyline Type Foundry LLC
- B53 Advanced Roller Company
- B73-B75 California Machinery Movers

3 GRAPHIC DESIGN SERVICES

- A01-A02 The Bieler Press
- A03-A04 Papermum Press
- A06 Modern Optic
- A10 Classic Letterpress
- A14 Just Vandy
- A19 Fugu Fugu Press
- A20-A21 Joie Studio Design and Letterpress
- B08 The Library Press
- B16 Poli Marichal Art Studio
- B28 Kiss and Punch Designs
- B29 Harry Diaz
- B32 Two Hand Design
- B40 Guild of Book Workers, California Chapter

- B50 Poet & Peasant Press
- B54 Panorama Press

4 PRINTMAKING/PHOTOGRAPHY

- A05 Krank Press
- A08 Erynn & Camilla
- A09 Jill K. in LA
- A10 Classic Letterpress
- A11 Buddha Cat Productions
- A13 Stacy Wong
- A17 Los Angeles Printmaking Society
- A22 Picture Books
- B16 Poli Marichal Art Studio
- B18 DTLA Print
- B20 Hyacinth Press
- B24 Legion Paper
- B27 C.J. Whitlock
- B29 Harry Diaz
- B32 Two Hand Design
- B33, B41 Margins
- B34 Eva Svitek
- B35 Panicle
- B37-B38 BookArtsLA
- B40 Guild of Book Workers, California Chapter
- B50 Poet & Peasant Press
- B54 Panorama Press

5 BOOK ARTS/ARTISTS BOOKS/ RARE BOOKS

- A03-A04 Papermum Press
- A07 Pie in the Sky Press
- A08 Erynn & Camilla
- A10 Classic Letterpress
- A11 Buddha Cat Productions
- A14 Just Vandy
- A22 Picture Books
- A23 Otis Lab Press
- B08 The Library Press
- B16 Poli Marichal Art Studio
- B29 Harry Diaz
- B33, B41 Margins
- B34 Eva Svitek
- B35 Panicle
- B36 Marie Kelzer Designs
- B37-B38 BookArtsLA
- B40 Guild of Book Workers, California Chapter
- B43 VigodaPress
- B44
- B45 Kater-Crafts Bookbinders
- B51 Occidental College
- B52 WNY Book Arts Center
- B54 Panorama Press

6 PAPER

- A03-A04 Papermum Press
- A08 Erynn & Camilla
- A18 Paper Pastries
- A22 Picture Books
- B03-B04 Kelly Paper
- B05 Washi Arts

- B12 French Paper
- B15 Neenah Paper
- B17 De Milo Design Studio & Letterpress
- B23 Hiromi Paper
- B24 Legion Paper
- B30 Astro Paper
- B36 Marie Kelzer Designs
- B40 Guild of Book Workers, California Chapter
- B42 Parasol Paperworks

7 EDUCATION/CLASSES

- A01-A02 The Bieler Press
- A03-A04 Papermum Press
- A06 Modern Optic
- A07 Pie in the Sky Press
- A10 Classic Letterpress
- A11 Buddha Cat Productions
- A12 TypeEd
- A17 Los Angeles Printmaking Society
- A23 Otis Lab Press
- B01-B02, B09-B10 Letterpress Things
- B07 Printing Industries Association (PIASC)
- B16 Poli Marichal Art Studio
- B17 De Milo Design Studio & Letterpress
- B21 Irvine Fine Arts Center
- B22 American Printing History Association, Southern California (APHASC)
- B23 Hiromi Paper
- B36 Marie Kelzer Designs
- B37-B38 BookArtsLA
- B40 Guild of Book Workers, California Chapter
- B51 Occidental College
- B54 Panorama Press

8 MISCELLANEOUS

- A03-A04 Papermum Press
- A08 Erynn & Camilla
- A11 Buddha Cat Productions
- A13 Stacy Wong
- A17 Los Angeles Printmaking Society
- B05 Washi Arts
- B07 Printing Industries Association (PIASC)
- B13 Ramco Roller Products
- B18 DTLA Print
- B19 Warren Tales
- B22 American Printing History Association, Southern California (APHASC)
- B23 Hiromi Paper
- B26 Typecraft Wood & Jones
- B33, B41 Margins
- B37-B38 BookArtsLA
- B40 Guild of Book Workers, California Chapter
- B42 Parasol Paperworks
- B45 Kater-Crafts Bookbinders
- B50 Poet & Peasant Press
- C05 Tikiranch

THE PEARL

Is Without a Peer among Low Price Presses, and is

UNEQUALED FOR EASE AND RAPIDITY OF MOTION.

They never fail to give perfect satisfaction; are simple, strong, serviceable and durable; and the smaller sizes are designed especially for those small jobs every office has, and which it does not pay to run on the larger and more expensive presses. One customer writes that he prints a magazine two pages at a time, which completely fills the chase; another, (who uses six or eight) that one of his young men recently run off 50,000 envelopes in two days of ten hours each. We could quote indefinitely.

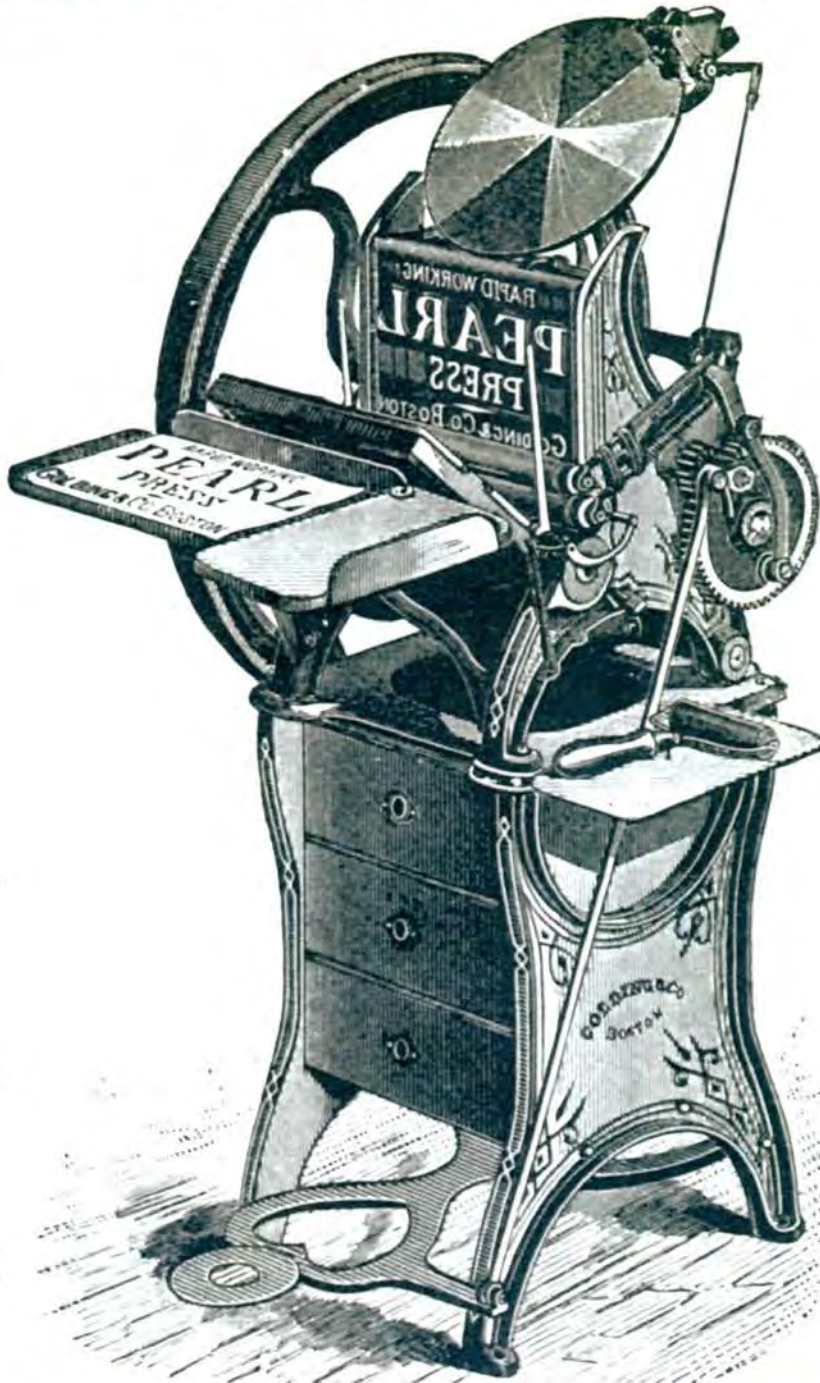

No. 1—5 x 8 inside chase.....	\$ 70
No. 3—7 x 11	110
No. 5—9 x 14	180
“ “ with Throw-off.....	180

SIZES AND PRICES.

GOLDING & CO. { 177 TO 199 FORT HILL SQ. } **BOSTON, MASS.**
 { 19 TO 27 PURCHASE ST. }

Full details given in our Press and Tool Catalogue, which is sent free on application. Complete Catalogue, 10 cents.

OTIS

CONTINUING EDUCATION CLASSES
BFA BOOK ARTS MINOR

Otis Laboratory Press

9045 Lincoln Boulevard, Los Angeles, California 90045
Telephone | 310.665.6846 Email | labpress@otis.edu

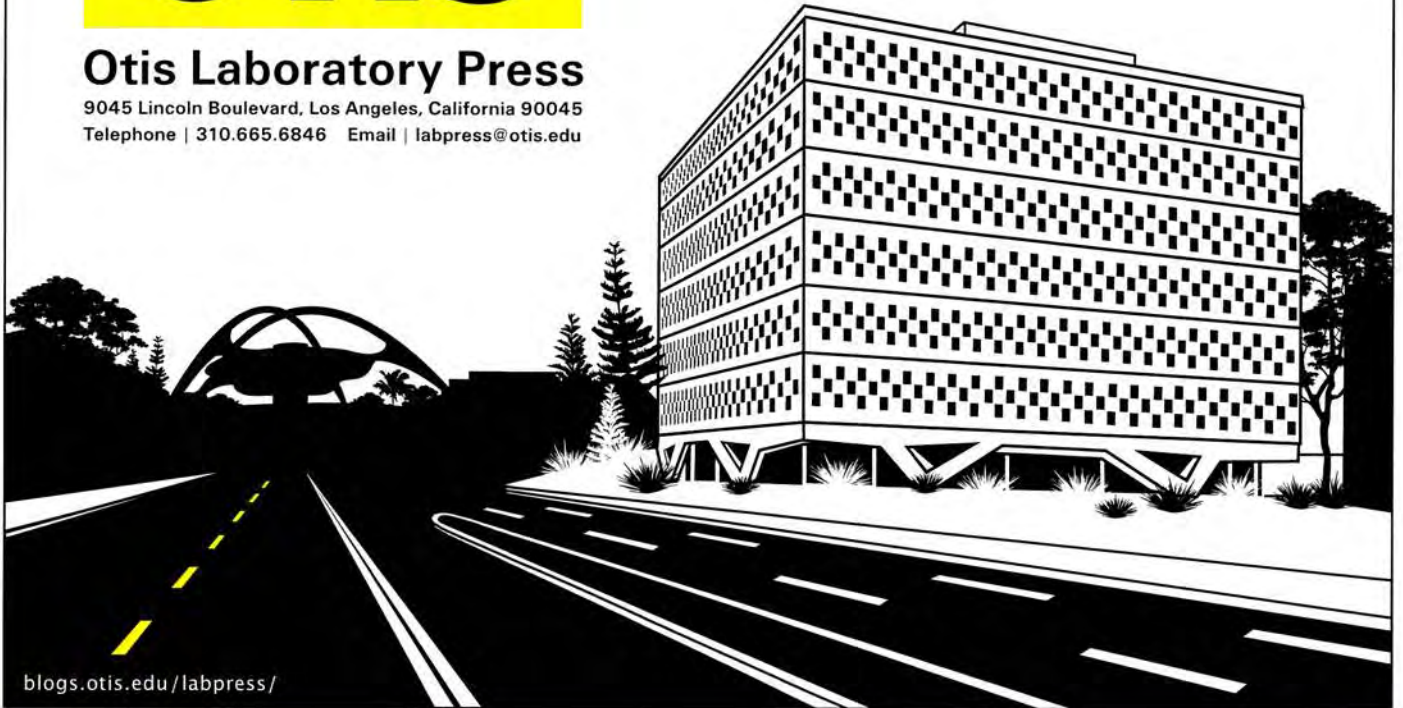

blogs.otis.edu/labpress/

BOOKS • TYPOGRAPHY • EPHEMERA • PRINTING • CALLIGRAPHY • PRIVATE PRESSES
TYPECASTING • PAPERMAKING • BOOKBINDING • ILLUSTRATION • PUBLISHING

AMERICAN PRINTING HISTORY ASSOCIATION

Explore printing history with the Southern California Chapter

Recent activities have included studio, gallery and library tours, printing workshops, film screenings, symposiums, and lectures throughout the Southland and beyond.

For more information, visit us at booth B46 or online at
www.aphasocal.org or www.printinghistory.org

SOUTHERN CALIFORNIA CHAPTER

Design by www.kristinavargas.com



ADVANCED ROLLER CO.

Specializing in Graphic Arts & Letterpress Rollers



Advanced Roller Company thank all of our Letterpress Friends all over the country for your continued business. We understand that many of you are not in this business to make money but are truly doing this for a passion that we support. We will do our best to fix any old Antique Rollers you may have and will recover any **Letterpress Rollers** large or small. Most orders are a one week turnaround. Remember, Advanced Roller is the only company in the country that can recreate "original C & P roller cores with the crimp to hold the trucks."

Let's keep the Letterpress going....

Denny Woodruff

212 Lewis Court • Corona, CA 92882

office@advancedroller.com

www.advancedroller.com

951-272-3010 • FAX: 951-272-4113



CHANDLER PRICE ROLLERS

12 X 18 \$89.00

10 X 15 \$79.00

8 X 12 \$69.00

PILOT \$59.00

(ALL WITH NEW CORES)

HEIDELBERG WINDMILL

10 X 15 \$99.00

(NEW CORE)

10 X 15 \$49.00

(RECOVER YOUR OLD CORE)

KLUGE ROLLERS

12 X 18 \$109.00

10 X 15 109.00

(WITH NEW CORES)

ASTRO

PAPERS

Paper

Domestic Mills
CTI, French Paper Co.,
Neenah Paper,
Mohawk, Reich Paper
International Mills
Curious Collection,
Gmund, Gruppo
Cordenons & more!



Full-sized *and* smaller cut-sized sheets.
Huge selection of matching envelopes.

Love

In addition to our
folio sizes, we also
offer the unique
ability to cut, score,
fold, die-cut,
and break cartons
of *any paper*
that we stock.

SAN MARCOS, CA • (800) 752 5003 • ASTROPAPER.COM

📱 @ASTROPAPER 📘 ASTROCONVERTERS • SINCE 1970

ASTRO

BOOK ARTS LA



www.bookartsla.org

BOOKARTSLA, a new, nonprofit organization

devoted to bringing the beauty of printing, binding
and collecting artists' and other hand made books
to the public. Our 1600 square foot space houses
letter presses, a bindery and workspace.

SCHEDULED EVENTS AT BOOK ARTS LA

Oct. 4 – BookArtsLA's at the annual Printers Fair

Oct. 9 – Kelly Kilmer

Oct. 17, 7-9pm –Third Thursday

Nov. 8 & 9 (all day) Rhiannon Alpers

Nov. 29 10am-5pm – HOLIDAY SALE

BOOKARTSLA

11720 Washington Place
Los Angeles, CA 90066
310-722-9004

Contact:

Marcia Moore
310-722-9004
info@bookartsla.org



People's Palace for East London,

MILE END ROAD, E.

PRIZE COMPETITION

FOR

LETTERPRESS PRINTING.

Designed & Composed by E. A. HODGES,

APPRENTICE IN THIRD YEAR WITH

Messrs. GREEN & McALLAN

3 LUDGATE GIRCUS.

London, & C.

AND 3 PLOUGH COURT, FETTER LANE, E.C.

AWARDED A SILVER MEDAL.





Join Us
at Booth A17
for print demos
and artist prints!

Prints support our LAPS
Student Scholarship Fund

The Los Angeles Printmaking Society

Since 1963, the Los Angeles Printmaking Society (LAPS) a non profit artist run organization, has been dedicated to educate and promote the interests of printmaking as an art form through a variety of exhibitions and symposia for the public, including scholarships for students, national and international print exchanges and the celebrated biennial LAPS National Print Exhibition, the largest such exhibition in Southern California.

Join us and support the Arts!

Join us online at:

www.laprintmakers.com



RAMCO

Roller Products

LETTERPRESS & PRINTING ROLLERS



**WE CAN RECOVER MOST
LETTERPRESS ROLLERS
for \$45 - \$75**

Please call or email us if you have any questions!

Ramco Roller Products

241 W Allen Ave • San Dimas, CA 91773
909-592-1002

ADRIAN & JAYNE RAMOS

Adrian@RamcoRoller.com

www.RamcoRoller.com

ART

BEGINS WHERE

GEOMETRY ENDS

PAUL STANDARD 1947 || *Typography Classes for the Masses.* TypeEd

CRANE'S LETTRA • STARDREAM • SO...SILK • WILD • CANALETTO GRANA
GROSSA PAPERS • STRATHMORE • ASPIRE PETALLICS • VANSON INKS



With a variety of fine papers and rubber base inks, Kelly Paper brings insights, ideas, and solutions that matter to customers and partners across the board. We have an ink lab, cut sheets, cards, and matching envelopes to satisfy your creativity.

OPEN TO THE PUBLIC!

KELLY | PAPER®

47 Store locations to service you
800-67-KELLY | www.kellypaper.com

“Recognizing
the Need is the
Primary
Condition
for Design”
Charles Eames



SIMPSON PIRTLE DESIGN

art direction | design

714-288-9993 | www.simpsonpirtle.com

Highest Quality
Garment Printing

AND FINISHING SERVICES

PROFESSIONAL X EXPERIENCED



**DT
LA**

PRINT

**ALL OVER DYE SUBLIMATION
FULL COLOR DIGITAL PRINTS
SPECIALTY PRINTS
JAPANESE & ITALIAN INKS
PHOTOGRAPHIC SCREEN PRINTS
JUMBO 30" X 34" ALL OVER PRINTS
FULL FINISHING SERVICES**

**DTLAPRINT.COM 323 • 261 • 8700
SALES @ DTLAPRINT.COM**

USE CODE: DTLASHOW10 GET 10% OFF FIRST ORDER

KATER- CRAFTS BOOKBINDERS

FINE BOOKBINDING

◆ SINCE 1948 ◆

PICO RIVERA, CALIFORNIA
562 692-0665

WWW.KATERCRAFTS.COM

KATERCRAFTS@EARTHLINK.NET

Equipment Specialist
**CALIFORNIA
MACHINERY
MOVERS** *Est. 1991*



Toll Free 800-675-1548

714-740-1520 ★ 213-388-9899

WWW.CALIFORNIAMACHINERYMOVERS.COM

INTRODUCING THE HP INDIGO 10000 DIGITAL PRESS

SOMETIMES YOU DON'T NEED TO PRINT 5000 COPIES OF YOUR PROJECT.

SOMETIMES YOU ONLY NEED 500, OR JUST FIVE *PERSONALIZED* COPIES.

— TYPECRAFT

2040 East Walnut Street, Pasadena, California 91107
626.795.8093 | typecraft.com



A & G ENGRAVING, INC.

MANUFACTURER OF QUALITY COPPER & MAGNESIUM ENGRAVINGS

Specializing in

Foil Stamping, Embossing and Letterpress Engravings

FIRST IN KNOWLEDGE & EXPERIENCE

At A & G Engraving craftsmanship, quality and over 40 years experience are the key to the outstanding images created from our engravings.

FIRST IN QUALITY

Our engravings must pass stringent quality assurance inspections. The etch must be clean and precise and be able to produce fine detail.

FIRST IN SERVICE

Most dies are produced within 24 hours.
Dies are shipped by UPS or a carrier of your choice.

FIRST IN RANGE OF PRODUCT

We customize your die and letterpress engravings to meet your printing requirements.



Let Us Assist You With Your Next Project!

(323) 583-9085

3846 S. Santa Fe Ave. • Los Angeles, CA 90058
aandgenraving@gmail.com • www.aandgenraving.com



From sustainable forests to the renewable nature of trees and the recyclability of paper, the print and paper industries have a positive environmental story to tell—one in which print on paper and healthy forests thrive hand-in-hand.

The truth is, print is recyclable, renewable and responsible.

Let's examine the facts:

Paper is Recycled Daily: 87% of Americans have access to curbside or drop-off paper recycling programs and 63.5% of all paper consumed in the United States was recovered for recycling in 2010.

Recovered by Paper Mills: 115 paper mills in the United States used recovered fiber exclusively in 2010, and 289 more, or 77%, used at least some recovered material in their manufacturing process.

More Forests Exist Today: 12 million more acres of forest exist in the U.S. today than 20 years ago.

More Trees are Standing Today: 49% increase between 1953 and 2006 in the number of trees still standing after mortality and harvesting.

More Trees are Planted Daily: 1.7 million trees are planted every day by the U.S. paper and forest products industry; and 600 million annually worldwide.

Is a Small Portion: Just 11% of the world's forests are used for paper (28% for lumber; 53% for fuel).

Uses "Waste": 33% of paper comes from wood chips and sawmill scraps; another 33% comes from recycled paper.

Is Grown on Farms: 56% of all the forested land in the United States is privately owned. Nearly all wood used in the production of paper comes from trees grown on these privately-owned "tree farms."

Promotes Trees: Print helps give private landowners a financial incentive to grow trees and not sell off their land for other uses.

Learn more at ChoosePrint.org



PRINTING INDUSTRIES Association

5800 SOUTH EASTERN AVENUE SUITE 400
LOS ANGELES, CALIFORNIA 90040
(323) 728-9500

Dear Printer,

Since 1935, the Printing Industries Association, Inc. of Southern California (PIASC) has been helping letterpress shops, large and small, run the business part of their company. As a letterpress shop owner, you deal with a variety of issues including government compliance, HR issues, recruiting, employee training, benefits administration, and more. PIASC offers resources to help you in your efforts. And, we've been doing this, from a graphic arts perspective, for over 75 years.

- PIASC has negotiated discounts on equipment and supplies you need to run your business.
- PIASC can help you comply with complex governmental rules and regulations, and help reduce your risks for costly fees, fines, and litigation.
- PIASC has the tools to help you manage your people. We have an experienced and effective HR Director ready to assist you.
- PIASC helps you manage your risk with workers' compensation and group coverage exclusively designed for PIASC members.

If you would like to understand how PIASC can help your letterpress shop, please give me a call at (323) 728-9500 x209. You can also send an email to jay@piasc.org.

Sincerely,

Jay Haddad

Jay Haddad
Director, Industry Relations

DEGENER & WEILER'S

"LIBERTY"

Treadle Card and Job Printing Presses.

GOLD MEDAL, Exposition Internationale, Paris, 1875;
Philadelphia International Exhibition, 1876;
Vienna, 1873; London, 1862; Manchester, 1857; Santiago de Chili, 1875; Paris, 1867.



The following are the Advantages of this Press over all others:

Simplicity of Construction and Strength of Build— in which the Best Materials are used; Ease of Running; the Ability to Print a Form as large as can be locked up in the Chase; convenience of Making Ready, Adjusting or Cleaning; facility of Correcting a Form without removing it from the bed, as it can be brought into nearly a horizontal position.

Three rollers may be used for inking a form. These are held in stationary fixtures, without springs, and are readily removed by the operator without soiling his fingers.

Size No. 2 has a special arrangement for printing cards, by means of which cards are dropped into a box below, or may be retained on the platen for examination.

While the impression is being taken, the form, the platen, and the ink distributing table are brought before the eye of the operator; and the inking rollers are always in sight.

The face of the bed never moves beyond the vertical line, therefore no type can drop out.

The fly-wheel may be run either way without altering the working of the press.

The speed is, according to the ability of the operator, from 1,000 to 2,000 per hour.

NEW SIZES AND REDUCED PRICES OF THE "LIBERTY."

No. 2.—Inside of Chase, 7x11, with Card Drop,	\$215.00.	Fountain,	\$25.00.	Boxing,	\$6.00
No. 2A.— " 9x13,	250.00.	"	25.00.	"	6.00
No. 3.— " 10x15,	300.00.	"	25.00.	"	7.50
No. 4.— " 13x19,	400.00.	"	25.00.	"	10.00

Steam Fixtures for either size, \$20. Three Chases, two sets of Roller stocks, one Roller Mould, one Hand Roller, and two Wrenches go with each Press.

For **CLEARNESS** and **DISTINCTNESS** of Impression, **PERFECT DISTRIBUTION** of the Ink, **ACCURACY** of REGISTER, and the **EASE AND SPEED** at which they can be propelled by Treadle without **WEARYING** the operator **CANNOT BE EXCELLED.**

DEGENER & WEILER, Manufacturers,

23 Chambers St., cor. Centre, NEW YORK.



Washi Arts

Premium hand and machine made Japanese papers for book artists, printers, designers, fine artists, calligraphers, printmakers and bookbinders.

wa meaning Japanese + **shi** meaning paper

washiarts.com

San Francisco, CA 415 886 7096



Save the Date!
for the 7th Annual
Los Angeles Printers Fair



Saturday, October 3, 2015 | 9 am–4 pm
at The International Printing Museum

To learn more visit our website at
www.printmuseum.org/printersfair

COME ONE!
Come All!

And follow us on:



Please post comments, photos and videos from the Fair!

THE INTERNATIONAL PRINTING MUSEUM PRESENTS

VICTORIAN
FESTIVITIES
TO ENJOY



FUN-FILLED
FOR THE ENTIRE
FAMILY!

DICKENS

HOLIDAY CELEBRATION

• 2014 •

SATURDAY, DECEMBER 13

SUNDAY, DECEMBER 14

10 AM } Doors Open and the Celebration Begins!

10 AM } Doors Open and the Celebration Begins!

11 AM } An audience "interactive" recreation of
1 PM } *A Christmas Carol* with Charles Dickens
3 PM } of London, England"

11 AM } An audience "interactive" recreation of
1 PM } *A Christmas Carol* with Charles Dickens
3 PM } of London, England"

BOTH DAYS 10AM-4PM

THROUGHOUT THE DAY: CHRISTMAS CAROLS, PRINT YOUR
OWN VICTORIAN CARDS, & ENJOY A TASTE OF DICKENS

CALL FOR RESERVATIONS: 310-515-7166

\$20 PER PERSON OR \$70 GROUP OF FOUR RATE

*Reservations for performances highly recommended.

MUSEUM MEMBER DISCOUNT: \$16 PER PERSON OR \$60 GROUP OF FOUR RATE

Includes lunch of sausage, gingerbread & apple cider.

Advance tickets can be purchased online at printmuseum.org/dickens

315 W. TORRANCE BLVD.
CARSON, CA 90745



WWW.PRINTMUSEUM.ORG
310-515-7166

Thank You

To ALL of OUR VENDORS, VOLUNTEERS, and VISITORS WHO HAVE
MADE the 2014 LOS ANGELES PRINTERS FAIR a GREAT SUCCESS!

FAIR VOLUNTEERS

The Museum's Leather Apron Docent Guild,
Numerous Community and Student Volunteers

We Appreciate Your Help!

FAIR SPONSORS

The Printing Industries Association Inc.
of Southern California PIASC
Neenah Paper

SPECIAL EXHIBITION

Kevin Bradley, *Church of Type*

SPECIAL THANKS

Thank you to all of our vendors for
making this year's Fair a success!

A special thanks to the following for
lending their talents for this year's Fair:

LA Printers Fair Cover Design

Printed at the Printing Museum on the
Heidelberg Cylinder Press by the
Leather Apron Docent Guild Team:
Armand Veronico, Dr. Leland Whitson,
Mike Powe, and Rich Tautenhahn

Show Guide Design

Simpson Pirtle Design, Orange

Printing Plates

A & G Engraving, Los Angeles

Show Guide Printing by

Fullerton College Printing Department Students

Paper Donated By

Neenah Paper

Fair Graphics and Support

Michael Powe Graphic Design, Torrance

The 6th Annual Los Angeles Printers Fair
supports the non-profit International Printing
Museum and its educational mission.

MUSEUM STAFF

Mark Barbour, *Founding Curator and
Executive Director*

Dr. Leland Whitson, *Docent Director*

Phil Soinski, Gary Marc Remson,
Walt Ratcliff, Peter Small

BOARD OF TRUSTEES

Dan Freedland, *President*

Ethan Lipton, *Vice President*

Doug Haines, *Secretary*

Bob Lindgren, *Treasurer*

Mark Barbour, *Executive Director*

Harriet Lindner, *Trustee*

Dr. Leland Whitson, *Trustee*

Paul Carney, *Trustee*

Dan Koon, *Trustee*

Frank Buono, *Trustee*

Hanna Wood McConaghy, *Trustee*

Carol Geddes, *Trustee*

Michael Druyen, *Trustee*

UPCOMING MUSEUM EVENTS

Dickens Holiday Celebration
December 13th and 14th, 2014

Ben Franklin Day
January 16th, 2015

Kids Crazy Krafts Day
April 4th, 2015

Boy Scout Merit Badge Days
Four Times a Year

www.printmuseum.org/specialevents

ETAOIN SHRDLU for GARY MARC REMSON

Following this year's LA Printers Fair, Gary Marc Remson will be retiring from the Printing Museum and heading north past Portland. For many years, Gary has been an integral part of the Museum's team. Gary has been the behind the scenes, and theatre curtains, person who has made sure so many things have happened at the Printing Museum. From working on and keeping running the temperamental Linotypes; wrestling with the computers, website and databases; teaching platen press classes; running the sound booth for all of our theatre shows; working with the many volunteers including chauffeuring Jack Conway; and keeping the Los Angeles Printers Fair organized and functioning from year one.

And all of this with his unique humor and entertaining quotes found on his collection of t-shirts! Gary, on behalf of all the Printing Museum's community, a BIG THANK YOU for all that you have done—you will be missed by all of us!

Mark Barbour, Executive Director & Founding Curator



Gary Marc Remson making a quick repair on the Museum's Linotype.





A LETTERPRESS COMMUNITY,
SHOWCASE & RESOURCE

THEBEAUTYOFLETTERPRESS.COM



by NEENAH PAPER

CRANE'S LETTRA® Cover FLUORESCENT WHITE 110C (297 g/m²)

© Registered Trademark of Neenah Paper, Inc. © 2014 NPI. All rights reserved. | CRANE and CRANE'S LETTRA® Registered Trademarks of Crane & Co., Inc.